



# Office of Nueces County Clerk Kara Sands

## Nueces County - New Voting Equipment

### STEP #1

# mark and print your ballot



- ▶ The ballot marking device is touch screen operated
- ▶ An accessible device with audio is also available
- ▶ Follow the instructions on the screen to:

- Enter your access code
- Insert your ballot paper
- Mark and print your ballot

1

Enter your access code and select **Accept**.

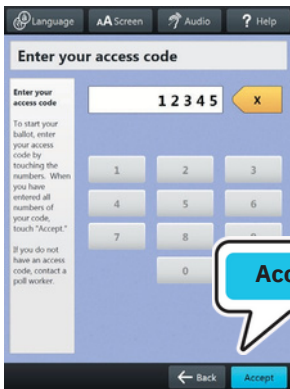

2

Insert one sheet of ballot paper as shown.

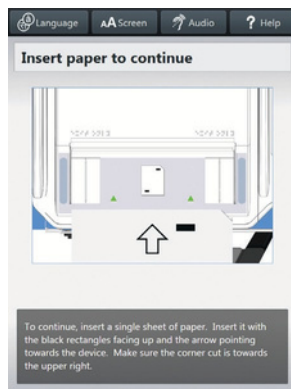

3

When ready, select **Begin Voting**.



4

Select your choice; select **Next** to go to the next contest.

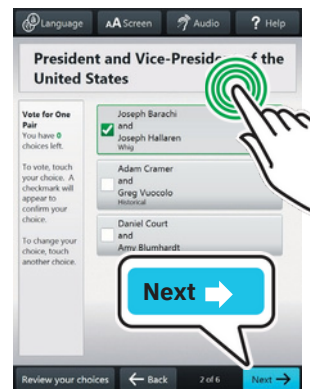

5

Review your ballot. When you're ready, select **Print Record**.

*If your ballot requires multiple sheets, you will be prompted when it is time to remove the first sheet and insert the next blank sheet.*

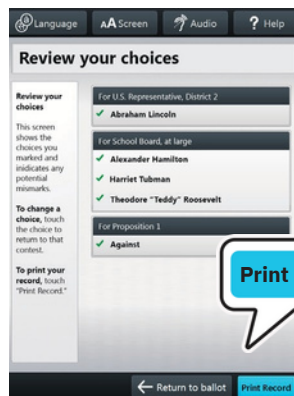

6

Retrieve your printed record and take all sheets to the scanner to cast your ballot.





# Office of Nueces County Clerk Kara Sands

## Nueces County - New Ballot Scanner

# STEP #2

## scan and cast your ballot



- ▶ The ballot scanner is touch screen operated
- ▶ Follow the instructions on the screen to:
  - Insert your ballot
  - Respond to any on-screen messages
  - Verify your ballot has been cast

1

Insert your ballot into the scanner as shown.

- ▶ *If your ballot contains multiple sheets, insert the first sheet.*



2

If there are any problems with your ballot, follow the instructions on the screen.

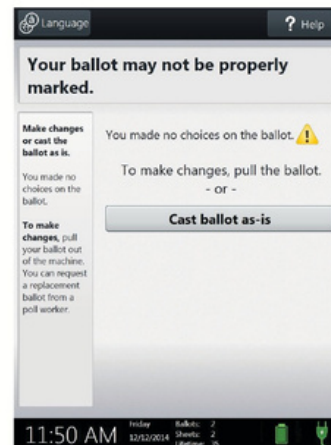

3

Your ballot is cast when you see the American flag or hear the chime.

- ▶ *If your ballot requires multiple sheets, repeat the process for each sheet.*

